

2000
Davis & Van Buren Counties, Iowa
Iowa South Zone (1402)
NAD_83(1996)

Point Number: 126

Northing: 268851.74(Ft) Easting: 2007664.60(Ft)

Northing: 81946.174(M) Easting: 611937.394(M)

Elev: 773.90(Ft) NAVD_88

Elev: 235.888(M) NAVD_88 Ellip Ht: 202.957(M) 96C Geoid Ht: -32.931(M)

Latitude: 40-43-48.913746 N Longitude: 92-10-29.514926 W

Theta: 0-52-22.32 Combination Factor: 0.99995005

Designation: DAVIS CO GPS CONTROL PT 2000-126

Monument Type: 5/8" dia driven aluminum rod with a 2-1/2" dia aluminum cap and permanent magnet encased in a 5" dia PVC pipe with an aluminum access cover.

To Reach: 30ft N of 227th St, approx. 0.65 mi E of Yukon Ave in the SW quarter of Sec 31 T69N R11W.

Date Printed July 25, 2000

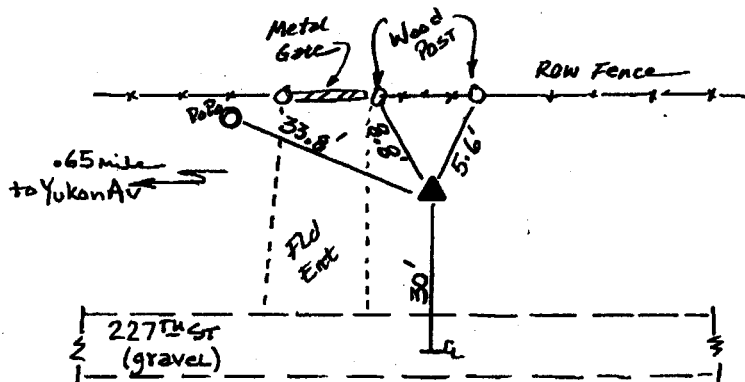

126
BRS/MAB
APRIL 2000